

# Senior Recognition Ceremony Shuttles (Saturday)

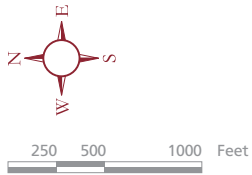

## SYMBOL KEY

- △ = Bus Stop
- = Event Location
- 31 = Parking Lot
- = SBS Shuttle
- ↻ = Circulating Buses

## EVENT KEY

- A MULLINS CENTER**  
9:00 – Isenberg School of Management  
1:00 – College of Social & Behavioral Sciences  
5:00 – College of Natural Sciences
- B REC. CENTER**  
9:00 – College of Engineering  
1:00 – College of Humanities & Fine Arts  
5:00 – College of Information and Computer Sciences
- C FINE ARTS CENTER**  
9:00 – College of Nursing  
1:00 – School of Public Health and Health Sciences  
*Kinesiology and Nutrition*  
3:30 – School of Public Health and Health Sciences  
*Communication Disorders and Public Health*
- D CAMPUS CENTER AUDITORIUM**  
9:00 – CPE & University Without Walls  
1:00 – Bachelor's Degree with Individual Concentration
- E GOODELL BUILDING**  
9:00 – College of Education

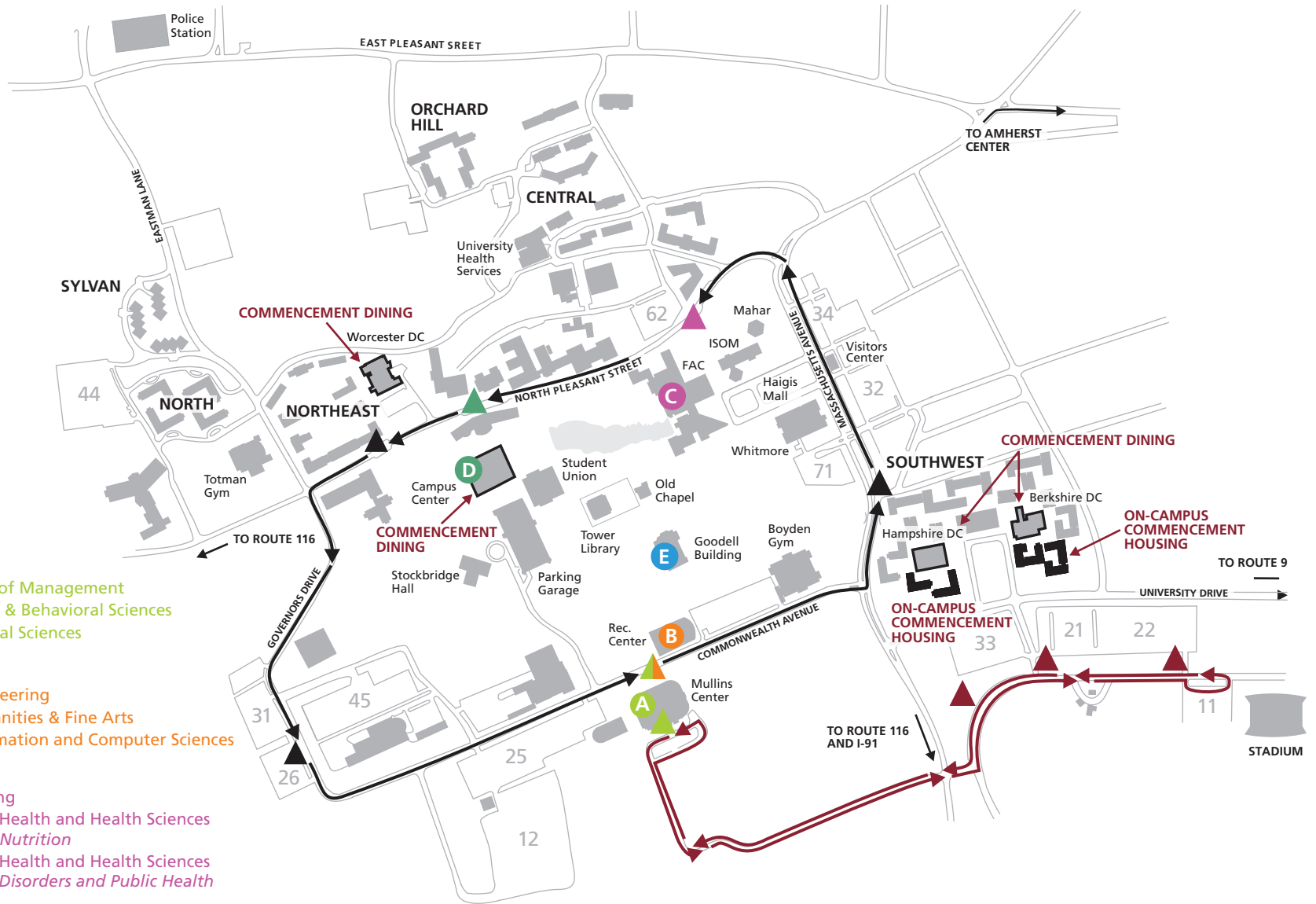

Buses will circulate around campus between 7:30 a.m. and 7:30 p.m., with a bus every 12 minutes. The SBS shuttle will run between 11:00 a.m. and 5:00 p.m.